

EN



Concorde

REISEMOBILE AUS LEIDENSCHAFT



CRUISER

THREE TIMES **PASSION.**

Redefining freedom starts for you with the choice of three different chassis: The Iveco Daily with its generous load capacity and an optional 8-speed ZF fully-automatic transmission and the Iveco Eurocargo, a "lightweight" commercial vehicle chassis with plenty of torque, a compressed air brake system and an engine brake that leaves no wishes unfulfilled. The Mercedes Atego is the highlight of our Cruiser chassis models. The technical details alone, with up to 12 tons of total weight, full air suspension, 8-gear automatic transmission and 6 cylinders with 220 KW/299 PS, will make any trucker's heart beat faster.



CONTENTS

4	CRUISER IVECO
26	CRUISER ATEGO
50	DESIGN AND MATERIALS
58	PASSION



THE CRUISER ON AN IVECO PLATFORM: IN GRAND **TRADITION.**



The Cruiser on an Iveco platform is the motorhome for active people. At the same time, it also embodies the tradition for which our company stands like no other model in the Concorde family. It contains the unique experience of 30 years of building over-cab berths. From the floor plan layouts, through berth sizes, to the stowage space concept, every detail of this motorhome is based on the knowledge gained in more than three decades. Get on board and experience the difference.



SHOW **SIZE.**



The perfect combination of mobility, performance and size: The cruiser with the Iveco base unites all components which turn a journey into a luxury journey in a truly impressive manner. The high loading capacity ensures that nothing has to stay at home which shouldn't stay at home and the rear drive in the two chassis versions allows for the necessary pulling power and traction which make even long trips fun.



SIMPLY A **WELL-ROUNDED** AFFAIR.

Living with Concorde round seating means living in harmony with yourself and your surroundings. The spacious layout, the carefully considered floor plans and the ergonomically optimised dimensions of seating and living room furniture ensure a pleasant and relaxing leisure experience even at first glance. The large windows, numerous lamps and spots result in an imposing impression of space in a bright and friendly living environment.









A THOUROUGHLY **UNIQUE** PLEASURE.

THE KITCHEN.

The kitchen is a clear statement of quality and function: Three-burner stove, single-lever mixer tap, stainless steel kitchen sink and round seating in the rear. The kitchen space sets new standards in terms of ergonomics, design and functionality. Thanks to intelligent stowage space above and below the mineral kitchen worktop, your cooking utensils will all disappear in next to no time. The large volume AES refrigerator gives you plenty of space for cool storage of typical market purchases.



SPACE **IN THE** TRUEST SENSE.



THE BATHROOM.

A spa-like oasis with an absolute premium appeal. The ingenious idea behind it all: The bathroom in the RRL alcove extends across the entire width with a washstand and what is a walk-in wardrobe on one side, and a convenient toilet and spacious shower on the other. Perfect for a fresh-up in the morning and certainly making any feelings of cramped space a thing of the past.



PURE **RELAXATION.**



THE SLEEPING SPACE.

To help you relax and unwind after a busy day, our designers have really thought of everything. Two comfortable longitudinal berths and an internal height of more than 800 mm give you the impression of a bedroom rather than an over-cab berth. The easy exit via sliding steps means that your partner can carry on sleeping undisturbed and ensures a safe way back into this cosy space.



FREEDOM **BEGINS WITH** FLEXIBILITY.

THE FLOOR PLANS.

Treat yourself to the freedom to configure your own custom dream motor-home. On two chassis and with eight different floor plans, the Cruiser offers plenty of scope for making your wishes and dreams come true.

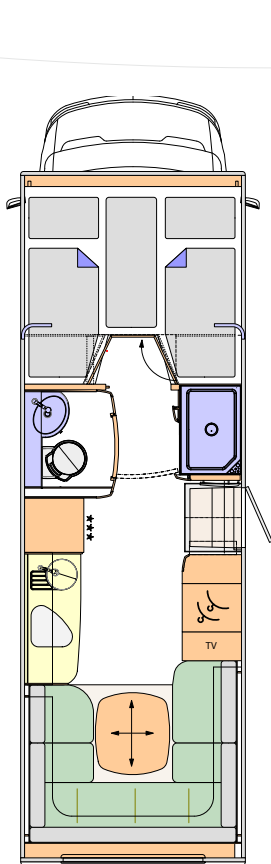

CRUISER IVECO 791 RL DAILY

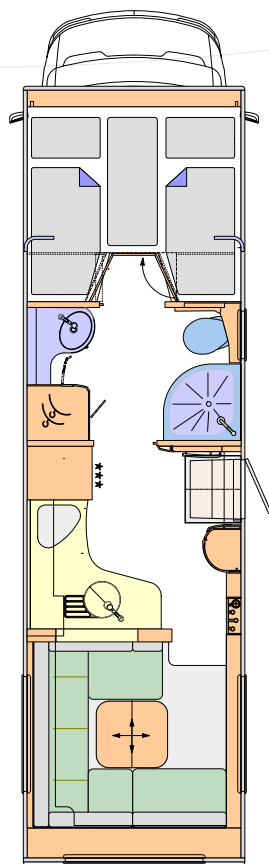

CRUISER IVECO 890 RRL DAILY

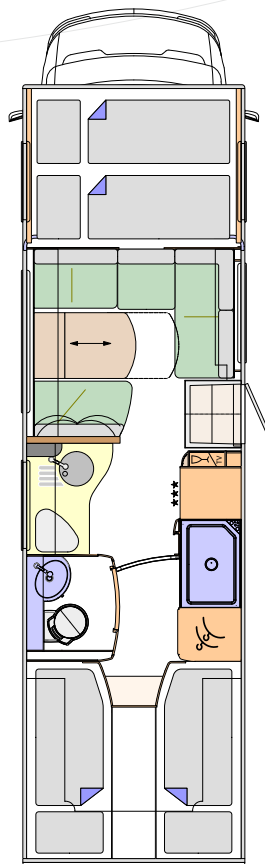

CRUISER IVECO 891 L DAILY

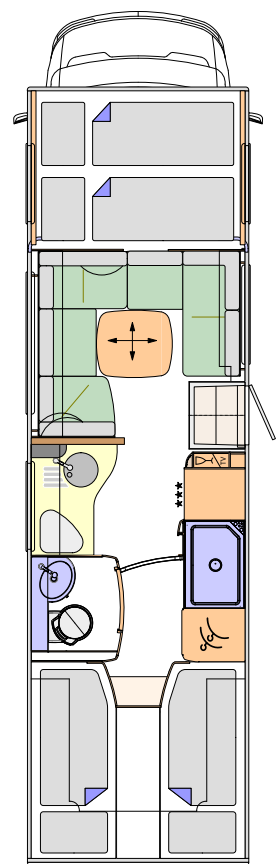

CRUISER IVECO 891 LR DAILY

"Our customers have dreams and we create the right spaces to make them come true."

Robin Schwarze, employee floor plan planning

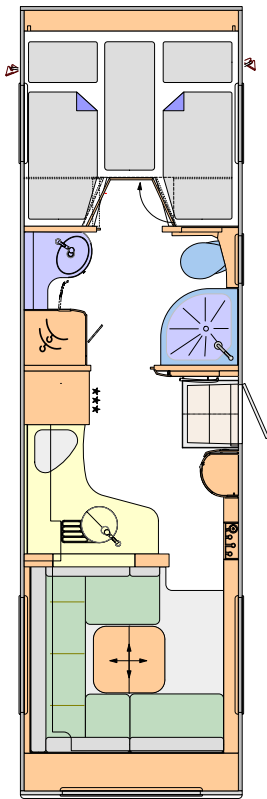

CRUISER IVECO 840 RRL EURO CARGO

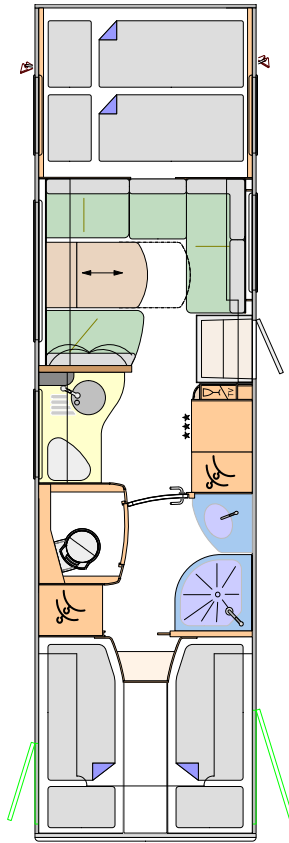

CRUISER IVECO 894 L EURO CARGO

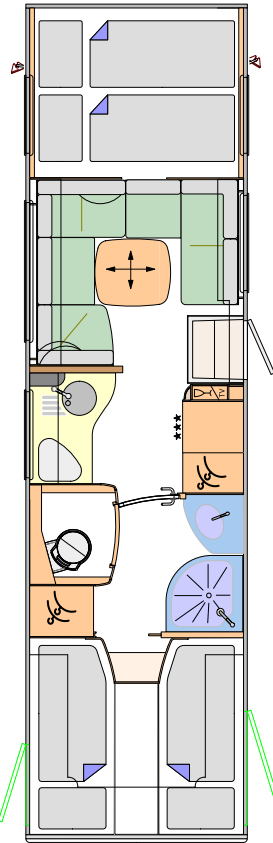

CRUISER IVECO 894 LR EURO CARGO

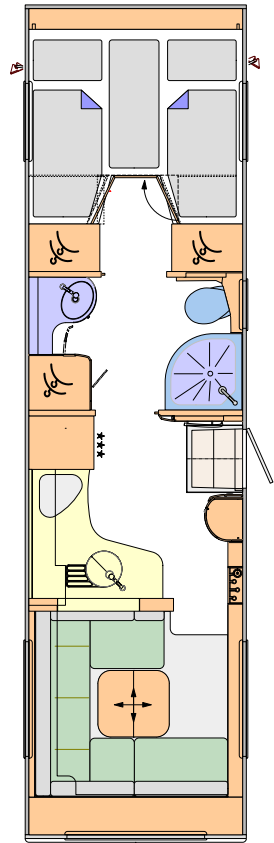

CRUISER IVECO 900 RRL EURO CARGO

THE CRUISER ON AN ATEGO PLATFORM: **POWERFUL AND PACKED** WITH IDEAS.



Experience pure freedom. The Cruiser impresses with its unbridled power and the highest level of functionality. The Mercedes Atego has a choice of four floor plans to choose from. A high seating position provides optimum all-round visibility, thus increasing safety on the road. Additional distinguishing features: Absolute winter hardiness, four exceptionally comfortable beds and an intelligent storage-space concept simply waiting to be packed chock full by you.



INDEPENDENCE **IN ITS MOST**
BEAUTIFUL FORM.



The Concorde Cruiser stands for a luxury class alcove which defines and unites terms like sense of space, quality, size, mobility and performance. With the Atego chassis, the rear drive ensures good traction and high carrying capacity for ample vehicle load capacity. Since size isn't everything, we have refined the floor plan versions; this results in the optimum combination of feel-good living space and a functional living environment – independence in its best form.



THINK IN **GENEROUS** TERMS.

THE LIVING ROOM.

Treat yourself to a journey without any restrictions in comfort. In an elegant and generous living environment with high-quality furniture, the Cruiser is also available in Noce with overhead locker furniture front panels in glossy cream white in the living area. Optionally, the furniture is also available in Atlas Cedar with overhead cabinet furniture front panels in Atlas Cedar with chrome handles or in Morettini Pear with overhead locker furniture front panels in high-gloss Morettini Pear. There is also an alternative to these three designs, namely overhead locker furniture front panels in high-gloss Senosan cream white. For a maximum in walking comfort, the floor coverings are available as standard in a ship's deck look or optionally in a slate look or in yacht-style.









AN INFINITELY VARIABLE **CONCEPT WITH** EXTENSIVE STORAGE SPACE.

THE KITCHEN.

Creative cooking means variety – even on the road. Adaptability is therefore the defining element in the Cruiser kitchen: Perfectly integrated kitchen utilities, the large-scale mineral kitchen worktop and an intelligent storage concept, create full independence while travelling. You only need to do the cooking.

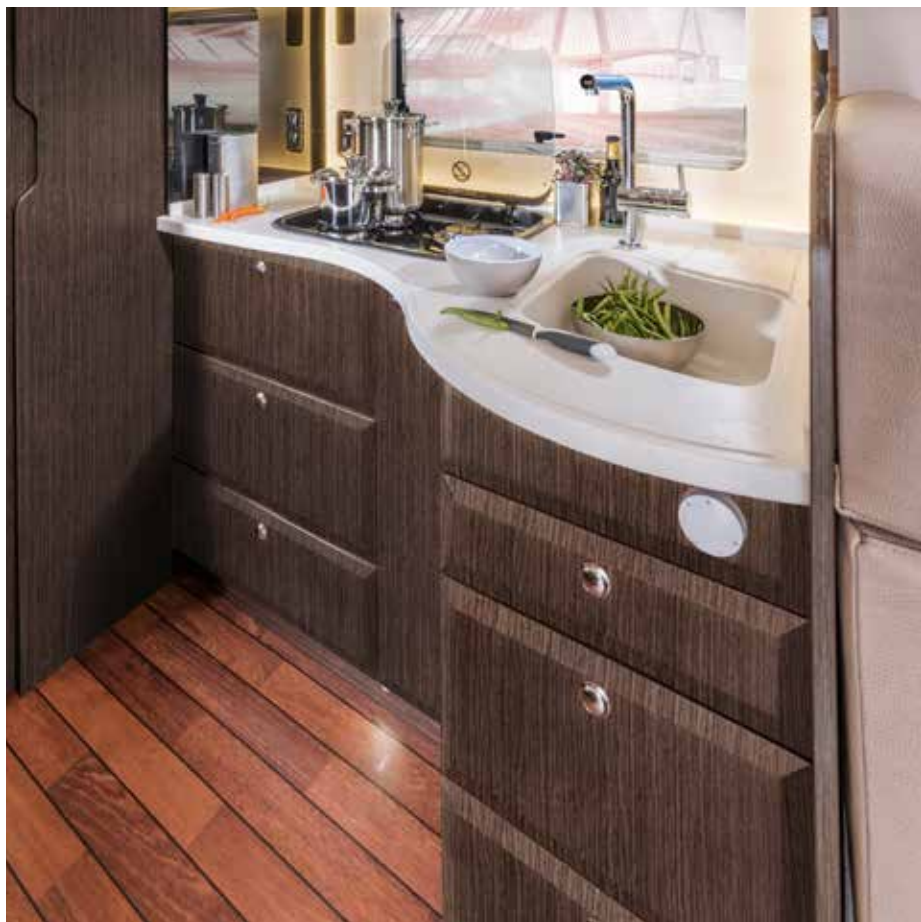





SPACIOUS AND **COSY.** **SOPHISTICATED** IN EVERY WAY.

THE BATHROOM.

The Cruiser even boasts high-end furnishings in its spacious premium bathroom with shower on one side and toilet on the other. Fresh and greywater tanks are generously dimensioned. The heated towel rail provides cosy warmth and the luxury of a warmed towel. Combine this with the underfloor heating and the bathroom becomes an oasis of spa-like proportions.



A PLAYGROUND
FOR YOUNG AND OLD.



THE SLEEPING SPACE.

The over-cab berth is the favourite place for children in a motorhome. In the Cruiser, that's also true for the adults. 70 centimetres of internal height provide unheard-of head clearance. The rear bed and the double over-cab berth are equipped with the comfortable Concorde mattress system. And if you do get out of any of these beds at night, the optional underfloor heating throughout the entire interior floor will ensure that you don't get cold feet.







EXTREMELY STRONG. EXTREMELY VARIABLE.

THE FLOOR PLANS.

A chassis for an imposing weight class: The Mercedes Benz Atego has a gross vehicle weight of up to twelve tons. There is a total of four floor plans with two rear bed versions available. You can choose between the standard seating area and a round seating area in both cases.

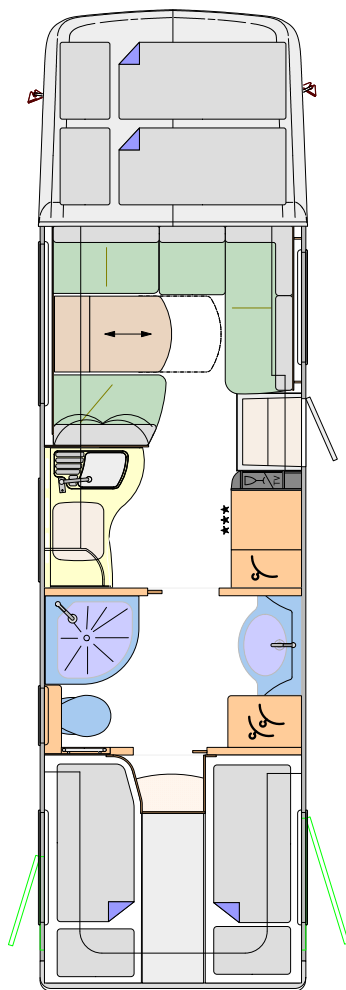

CRUISER 890 L MB ATEGO

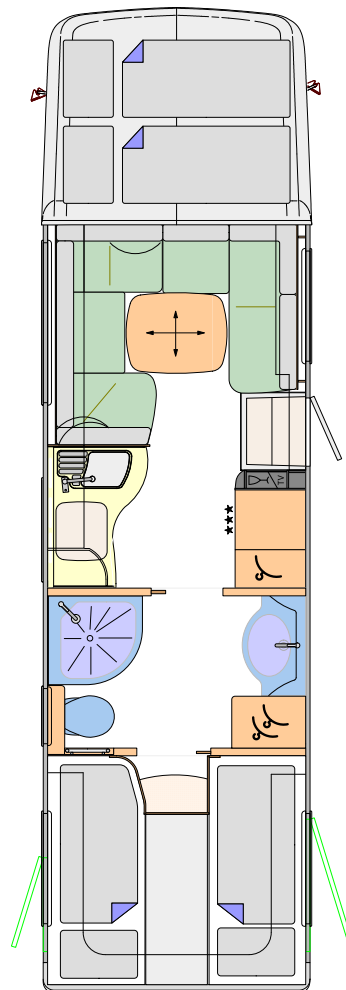

CRUISER 890 RL MB ATEGO

"Our customers have individual ideas – we offer individual solutions."

Axel Kirchhoff, employee floor plan planning

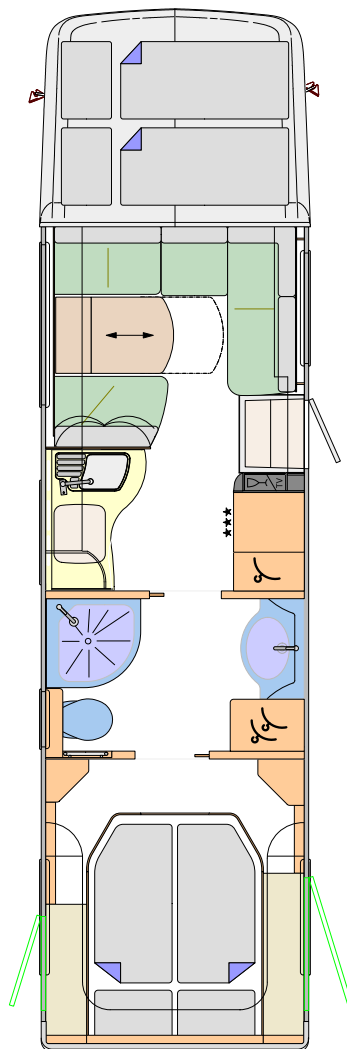

CRUISER 940 M MB ATEGO

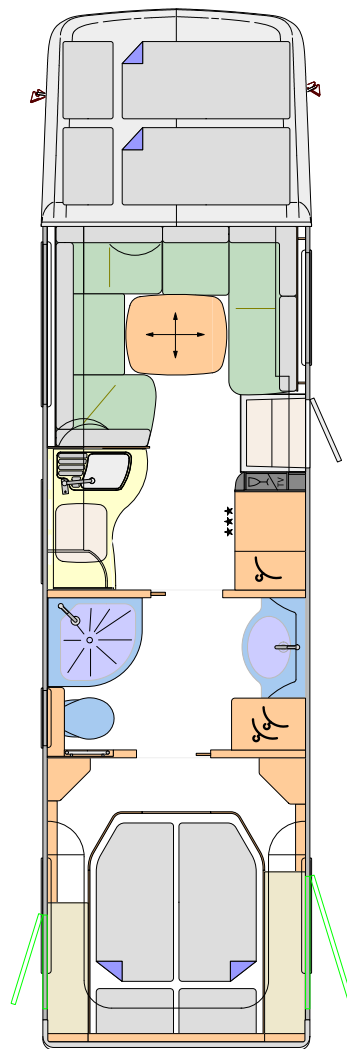

CRUISER 940 MR MB ATEGO

STYLISHLY **BALANCED.**



A Concorde is the perfect interplay of many individually customisable components. All models are characterised by intelligent details. The best materials and the best craftsmanship result in something that makes every one of our land yachts one-of-a-kind. Experience the extraordinary! No matter if you are on the road or have thrown down the anchor at your favourite spot.



THE FURNITURE LINES: SHOW STYLE.

THE DESIGN CONCEPTS.

Three different design options, both of which create a wonderful feeling of space. The Cruiser is available in the exquisite Noce look with glossy cream white overhead locker furniture front panels in the living area. The modern Atlas Cedar or the classic Morettini Pear looks are also available as options. For Atlas Cedar furniture, the Atlas Cedar overhead locker furniture front panels are equipped with handle bars in stainless steel look. Furniture versions in Morettini Pear follow classically elegant lines, the furniture front panels are delivered in a high-gloss Morettini Pear. The overhead locker furniture front panels are also available in high-gloss Senosan cream white for all three furniture lines. For a maximum in walking comfort, the floor coverings in a ship's deck look, slate look or yacht style are perfectly matched to the respective furniture.

STANDARD DESIGN VARIATION:



ROOF CABINET FRONT: GLOSSY CREAM WHITE
(ONLY LIVING ROOM)

BODY OF THE FURNITURE: NOCE

RECOMMENDED FLOOR COVERING: YACHT OPTIC

OPTIONAL FURNITURE FRONT PANELS:

"HIGH GLOSS" SENOSAN CREAM WHITE
(LIVING AND SLEEPING AREA)

CREATE YOUR OWN PERSONAL CONCORDE.

OUR OPTIONAL FURNITURE COMBINATIONS OFFER YOU THE POSSIBILITY TO DESIGN THE AMBIENCE ACCORDING TO YOUR OWN LIKING. AFTER ALL, INDIVIDUALITY IS IMPORTANT TO US.



ROOF CABINET FRONT: ATLAS CEDAR WITH HANDLE BARS IN STAINLESS STEEL LOOK
BODY OF THE FURNITURE: ATLAS CEDAR
RECOMMENDED FLOOR COVERING: YACHT-STYLE



ROOF CABINET FRONT: "HIGH GLOSS" SENOSAN CREAM WHITE
BODY OF THE FURNITURE: ATLAS CEDAR
RECOMMENDED FLOOR COVERING: YACHT-STYLE



ROOF CABINET FRONT: MORETTINI PEAR "HIGH GLOSS"
BODY OF THE FURNITURE: MORETTINI PEAR
RECOMMENDED FLOOR COVERING: SLATE LOOK



ROOF CABINET FRONT: "HIGH GLOSS" SENOSAN CREAM WHITE
BODY OF THE FURNITURE: MORETTINI PEAR
RECOMMENDED FLOOR COVERING: SLATE LOOK

ANTICIPATE MORE INDIVIDUALITY: CHOOSE A FLOOR COVERING TO MATCH THE FURNITURE AS YOU DESIRE.

EXPRESSIVE **AND** **PERFECTLY** MATCHED.

LEATHER AND FABRICS.

We offer a large selection of different full leather and microfibre covers; you can see some examples on the right side. All materials are finished with care in selected workshops in accordance with the strictest Concorde quality requirements. They are subjected to an innovative impregnating process so that they maintain their typical properties for as long as possible: Our microfibre fabrics are treated with ConLotus, our leather with Antisoiling Aquaderm X-Shield. Dirt does not stick, liquids roll right off, the look and smoothness stay the same. In addition, you can get the sitting area with the Redonda seat and back upholstery developed by Concorde on request: It ensures optimum hold, relaxes the spine and protects the lumbar region.



CLASSIC UPHOLSTERY:
CARAMEL FABRIC/MICROFIBRE UPHOLSTERY



UPHOLSTERY WITH THE REDONDA FOAM LOOK:
TOFFEE TEXTILE LEATHER



MAXWELL FABRIC/MICROFIBRE UPHOLSTERY

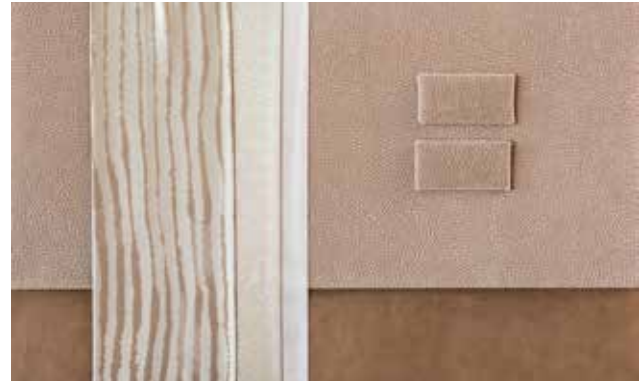

CARAMEL FABRIC/MICROFIBRE UPHOLSTERY



ISLAND FABRIC/MICROFIBRE UPHOLSTERY



TOFFEE TEXTILE-LEATHER UPHOLSTERY



COCO LEATHER UPHOLSTERY



SAVANNE OR **BICOLOUR SAVANNE/TERRA**
LEATHER UPHOLSTERY



CREME BEIGE OR **BICOLOUR CREME BEIGE/TERRA**
LEATHER UPHOLSTERY



"MOTHER OF PEARL" OR **BICOLOUR**
"MOTHER OF PEARL"/TERRA LEATHER UPHOLSTERY

THE STANDARD “**HIGHLIGHTS**” OF THE CRUISER.

MINERAL COMPOSITE KITCHEN WITH STAINLESS STEEL SINK.

The high-quality mineral kitchen worktop combined with the hygienic stainless steel sink is truly neat and clean. Well-thought-out details such as drip and water drainage troughs make housework easier. Clever idea: A support for the two-part sink cover turns it into an additional worktop. The extendable tap and the board for a Nespresso coffee machine are evidence of professional kitchen planning. Consistent furnishings are the sophisticated touch which makes all the difference.

SINE WAVE INVERTER 600 W.

The sine wave inverter continuously supplies small consumers such as chargers and ventilators with power. The mains priority circuit automatically turns the inverter voltage into shore power. The inverter is switched off and the vehicle battery is not unnecessarily strained when your motorhome is using shore power. If the external voltage fails, the inverter switches back on. This is important for connected 230 V consumers which are dependent on interruption-free voltage supply.

DOUBLE FLOOR STORAGE AREA.

The heated double floor with the enormous interior height of 420 mm offers a generous amount of storage space and is easily accessible through the large storage area flaps which can be rotated by 180°.



MINERAL COMPOSITE KITCHEN



SINE WAVE INVERTER 600 W



DOUBLE FLOOR STORAGE

INNER VALUES: **TECHNOLOGY** **AND** OTHER FEATURES.

FORWARD-THINKING SAFETY.

The emergency brake assistant and the lane departure warning system provided as standard ensure your safety. The radar system of the emergency brake assistant detects obstacles and intervenes if there is no driver activity, preventing serious accidents. The camera of the lane departure warning system helps the driver stay in the lane and warns him/her in a timely manner in the event that the lane is overrun.

JOHN GUEST HOME PIPING.

A water system like at home. With prefilter and high water pressure. The advantages are clear: No cross-section tapers with reduction in the flow rate at junctions, no loss of pressure as is the case with flexible hoses. Smooth interior walls prevent deposits and ensure better water hygiene, keeping everything neat and clean.

ALDE HOT WATER GAS CENTRAL HEATER.

The Alde hot water gas central heaters uniformly heat the vehicle, maintaining the natural air humidity. The temperature can be controlled as desired with the thermostat and a timer. Dust swirls – common with conventional fan heaters – do not occur. The boiler is equipped with electronic cartridges which can be inserted separately or together with the liquid gas. The Alde system features a non-return valve and an integrated hot water boiler which supplies all tapping points. It is part of the series equipment of all Concorde land yachts.



FORWARD-THINKING SAFETY



JOHN GUEST HOME PIPING



ALDE HOT WATER GAS CENTRAL HEATER

SECTIONAL DRAWING

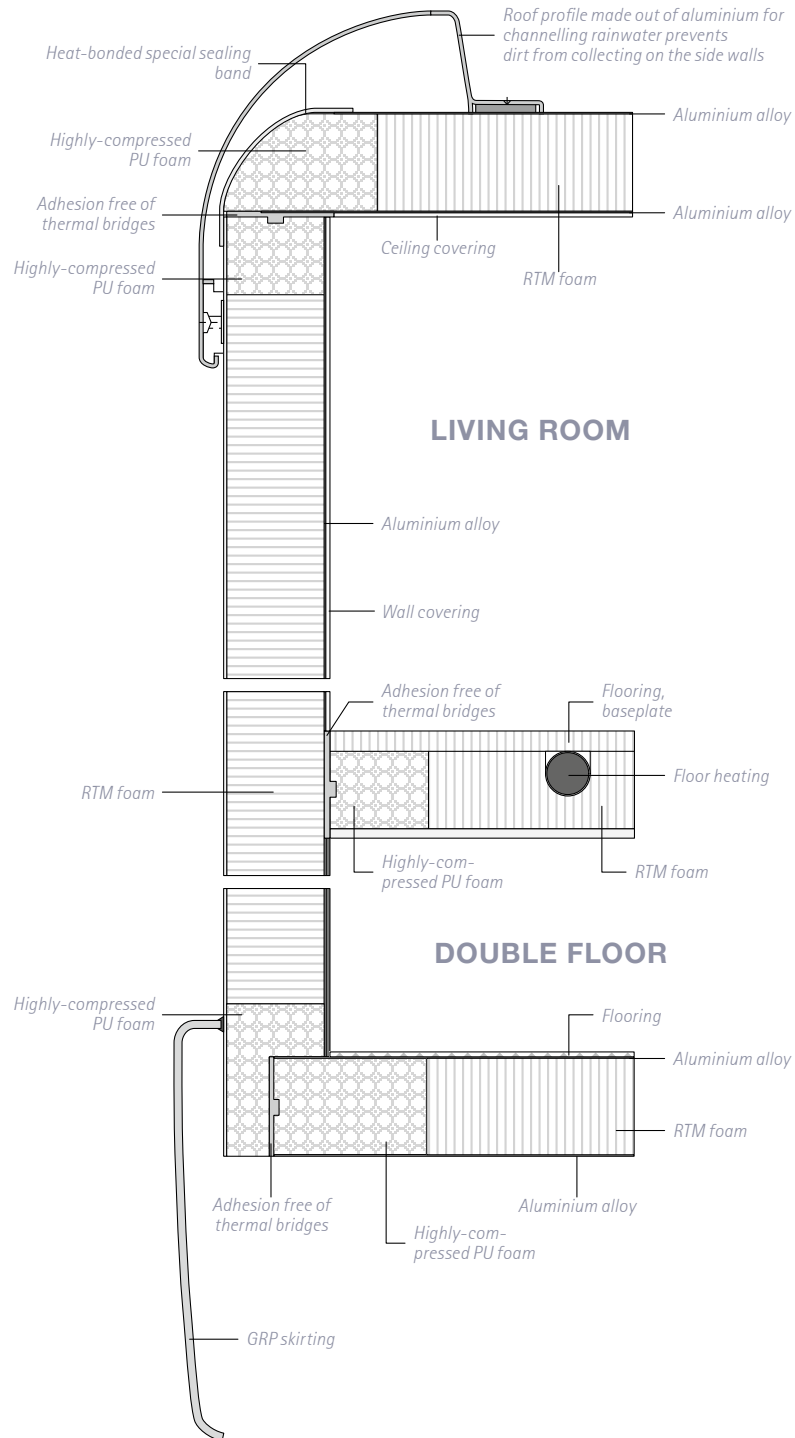

CABIN CONSTRUCTION **OF THE CONCORDE** CRUISER

When it comes to motorhome construction, Concorde stands for perfect insulation and excellent stability. The reasons for this are primarily the Solidtherm cabin construction, completely bonded and free of thermal bridges, with PU rigid foam strips as well as the side wall insulation with 38 millimetre-strong RTM foam. But that's not all: The underbody and in-between floors are manufactured in a sandwich design and equipped with a total of 70 millimetres of insulation. Side coverings, bumpers and front and rear sections are also made of highly-stable yet elastic fibreglass composite material.

The high-gloss and level wall surfaces made of aluminium composite make for a high-quality automobile appearance. And to make sure it stays that way, the aluminium roof profile strips with the rainwater channels effectively reduce the collection of dirt on the side walls. A 10-year impermeability warranty against moisture ingress from outside for the body of the vehicle with annual check in accordance with the Concorde guarantee conditions.



WE ARE PASSIONATE **ABOUT** MOTORHOMES.

THE ESSENCE OF MOBILE TRAVEL.

Concorde is committed to thinking like a manufacturer. We manufacture motorhomes of the highest quality for the highest demands. Every vehicle is unique, every vehicle is a masterpiece, classically hand-crafted in a traditional Franconian company, with unwavering passion, enthusiasm and inspiration. Because a passion for motorhomes is what unites the people at Concorde. And it is that which unites us with you.





Concorde

REISEMOBILE AUS LEIDENSCHAFT

Presented by your Concorde dealer:

Concorde Reisemobile GmbH
Concorde-Straße 2-4 · D-96132 Schlüsselfeld-Aschbach (Germany)
Phone +49 (0) 9555 9225-0 · Fax +49 (0) 9555 9225-44
Internet: www.concorde.eu · E-mail: info@concorde.eu

All information and figures apply for Concorde motorhomes from model year 2021. Model programmes, technical data and equipment features can differ from country to country. The design is based on StVO (German Road Traffic Act) and StVZO (German Road Traffic Licensing Regulations). We reserve the right to make changes, even without advance notice. Your Concorde dealer would be happy to give you current information. Please note that vehicles with special equipment are pictured which can deviate from the scope of delivery and standard equipment.